



CITY OF RICHLAND

2024 STORMWATER MANAGEMENT PLAN UPDATE

Eastern Washington Phase II Municipal Stormwater Permit No. WAR04-6006

PUBLIC WORKS DEPARTMENT

625 Swift Blvd. MS-26
Richland, WA 99352



Table of Contents

- A. Introduction
- B. Richland's Stormwater Utility
- C. Public Education and Outreach
- D. Public Involvement and Participation
- E. Illicit Discharge Detection and Elimination
- F. Construction Site Stormwater Runoff Control
- G. Post-Construction Stormwater Management for New Development and Redevelopment
- H. Municipal Operations and Maintenance
- I. Compliance with Total Maximum Daily Load Requirements
- J. Monitoring and Assessment
- K. Reporting and Record Keeping

Appendices

- 1. Stormwater Management Plan Inter-Departmental Coordination Procedures
- 2. Utility Billing Stormwater Insert
- 3. 2023 Illicit Discharge Investigations
- 4. Port of Benton Interlocal Agreement
- 5. 2023 Annexation Documents
- 6. 2023 Franklin Conservation District Education Report



A. Introduction

The City of Richland's (City) Stormwater Management Program is a living document, updated annually as needed to reflect the City's maturing programs to manage stormwater. This 2024 edition is built on the foundation of previous program documents and has been revised to reflect new activities and program requirements. The program is required by the Washington State Department of Ecology's National Pollutant Discharge Elimination System Phase II Permit for Eastern Washington (Permit). The Permit is comprised of six elements and the implementation and enforcement of the six elements is collectively referred to as a Permittee's Stormwater Management Program (SWMP). The six elements are:

1. Public Education and Outreach
2. Public Involvement and Participation
3. Illicit Discharge Detection and Elimination
4. Construction Site Stormwater Runoff Control
5. Post-Construction Stormwater Management for New Development and Redevelopment
6. Municipal Operations and Maintenance

In addition to these six minimum elements, Ecology requires three additional elements:

1. Compliance with Total Maximum Daily Load Requirements
2. Monitoring and Program Evaluation
3. Reporting and Recordkeeping

The SWMP is designed to reduce the discharge of pollutants from the City's Municipal Separate Storm Sewer System (MS4) to the maximum extent practicable to satisfy the state requirement to apply "All Known, Available, and Reasonable Methods of Prevention, Control and Treatment" (AKART) prior to discharge. The Permit requires that specified activities from Permit elements be completed each year in order to achieve full compliance by the end of each Permit term.

Within this SWMP document, a description of the City's permit compliance activities can be found. This includes information about the activities that took place during the previous year along with schedules for activities in the upcoming year. In 2024, the City's SWMP will be implemented in accordance with S5 of the 2019-2024 Permit. Planning and implementation of compliance strategies for the 2019-2024 Permit began when the new permit was issued in July 2019, and will continue throughout the remainder of the permit, in order to meet all requirements therein.

B. Richland's Stormwater Utility

Richland's Stormwater Utility was created to manage and maintain stormwater related infrastructure. Chapter 16.04.020 of the Richland Municipal Code (RMC) outlines the general responsibilities of the utility; "the utility is authorized to own, construct, maintain, operate, and preserve all stormwater infrastructure as now exists and as may be added to in the future by the addition of other existing or construction of storm drainage systems." Title 16 of the RMC further defines the authorities of the Stormwater Utility with additional chapters. These chapters outline the Stormwater Utility's authority for Illicit Discharge Detection and Elimination, Construction and Post-Construction Stormwater, Rates and Charges, and Administrative Enforcement Procedures.

C. Public Education and Outreach

Permit Requirement Summary (S5. B.1)

Implement a public education and outreach program for the general public, including home owners, teachers, school-age children, or overburdened communities that addresses:

- The importance of improving water quality and protecting beneficial uses of waters of the state. The potential impacts from stormwater discharges. Methods for avoiding, minimizing, reducing and/or eliminating the adverse impacts of stormwater discharges.
- Provide information to businesses and the general public about: preventing illicit discharges, including what constitutes illicit discharges, the impacts of illicit discharges, and promoting the proper management and disposal of waste. Management of dumpsters and wash water. The use and storage of automotive chemicals, hazardous cleaning supplies, carwash soaps, and other hazardous materials.
- Provide information to engineers, construction contractors, developers, development review staff, and land use planners about: technical standards, the development of stormwater site plans and erosion control plans. Low impact development (LID) and stormwater best management practices (BMPs) for reducing adverse impacts from stormwater runoff from development sites. Municipal stormwater requirements.

In an effort to promote discussion and awareness about stormwater amongst the target audiences, the City of Richland continues to provide education and outreach activities throughout the year. Descriptions of the outreach activities that took place during 2023 and a schedule of the planned activities for 2024 are below.

HBA Home and Garden Show & Salmon Summit

The City helped sponsor and staff booths at the Regional Home and Garden Show and Salmon Summit. These booths are a joint effort between West Richland, Kennewick, Pasco, and Franklin Conservation District. Booth visitors answer stormwater related questions to receive stormwater themed prizes. Educational brochures and handouts are also given.



Drain Rangers and Wheat Weeks

The City of Richland entered into an agreement with Pasco, Kennewick, West Richland and the Franklin Conservation District in 2010 to provide educational programs to local school children in the Tri-Cities area. These programs have continued on an annual basis. The Drain Rangers and Wheat Weeks programs are focused on educating children about the environment. Topics include the water cycle, watersheds, and stormwater runoff, including the impacts that it can have on the environment. 2023 data on total number of students and teachers involved in these programs are located in appendix 6.



Benton Conservation District Salmon Summit

In 2023, the City was able to have a booth at the Salmon Summit. This annual event is focused on student education and features multiple educational booths in Columbia Park. The kids rotate from booth to booth throughout the day, learning about a variety of topics. The City’s booth includes a stormwater and wastewater educational talk for the students. Afterwards the students complete a corn hole toss game and each are a fish/water themed prize that includes the City’s illicit discharge hotline.

City Fair and National Night Out

In 2023, the City of Richland held their annual City Fair event which provides outreach and exhibitions of the multiple departments that make up the City’s operations. A booth promoting awareness of the Stormwater and Wastewater departments was held at this event.

Developer, Contractor, and Engineer Outreach

Information for developers, contractors, engineers and other consultants involved with land development is always available on the City website and in the Public Works Department office. An informational handout provided to the development community through the development department covers the construction and post-construction stormwater requirements. Along with explaining the requirements that must be met, this document provides examples and information about where to find further guidance.

Schedule of Public Education and Outreach Activities for 2024

Date	Activity
Ongoing	Drain Rangers and Wheat Weeks Programs
February 2024	HBA Regional Home and Garden Show
April 2024	Salmon Summit
August 2024	City Fair and National Night Out
October 2024	Riverfest
October 2024	Stormwater Utility Billing Insert

In 2024, the existing program for Public Education and Outreach will continue in accordance with S5. B.1 of the 2019-2024 Permit. Planning and implementation of compliance strategies for the 2019-2024 Permit began when the new permit was issued in July 2019, to meet all requirements therein.

D. Public Involvement and Participation

Permit Requirement Summary (S5. B.2)

- Provide ongoing opportunities for public involvement and participation such as advisory panels, public hearings, watershed committees, participation in developing rate-structures, or other similar activities.
- Implement a program or policy directive to create opportunities for the public to provide input during the decision-making processes involving the development, implementation and update of the SWMP.
- Post the updated SWMP and annual report on the City's website by May 31.

The City of Richland is always open to comments from the public. The stormwater utility webpage on the City's website has contact information for both the Stormwater Manager and the Stormwater Maintenance Supervisor.

Public Comment Period for SWMP Update

To garner comments on the 2023 SWMP Update, the City of Richland uploaded a draft document to its website for a period of review. No significant comments were received.

Program Elements for 2024

In 2024, the City will continue to provide opportunities for citizens to provide feedback on stormwater issues. By April, a draft version of the SWMP Plan Update will be posted on the City website and a notification requesting public comments will be publicized. An open house may also be held to provide a chance for the public to ask questions and provide input to City staff about the SWMP Plan Update. After collecting and discussing the Public's comments and suggestions, City staff will make any necessary changes to the SWMP Plan and by May 31 will post the final version on the City website.

In 2024, the existing program for Public Involvement and Participation will continue in accordance with S5.B.2 of the 2019-2024 Permit. Planning and implementation of compliance strategies for the 2019-2024 Permit began when the permit was issued in July 2019, in order to meet all requirements therein.

E. Illicit Discharge Detection and Elimination

Permit Requirements Summary (S5. B.3)

- Continue to maintain and update a map of the MS4, showing the location of all known and new connections to the MS4 authorized or approved by the Permittee; all known outfalls; the names and locations of all waters of the state that receive discharges from those outfalls; and areas served by discharges to ground.
- Implement an ordinance or other regulatory mechanism that prohibits illicit discharges and authorizes enforcement actions, including on private property. The ordinance shall include escalating enforcement procedures and actions.
- Implement an ongoing program designed to detect and identify illicit discharges and illicit connections into the Permittee's MS4.
- Publicize a hotline for public reporting of spills and other illicit discharges.
- Implement an ongoing program designed to address illicit discharges, including spills, and illicit connections into the MS4.
- Provide training to staff who are responsible for the identification, investigation, termination, cleanup, and reporting of illicit discharges, including spills, and illicit connections to conduct these activities.
- Track and maintain records of the activities conducted to meet the IDDE requirements.

The City has an Illicit Discharge Detection and Elimination (IDDE) program in place to detect, investigate, and eliminate all illicit connections and discharges to the City's MS4. This program is implemented through the coordination of City staff in multiple departments. The general public also plays an important contributing role through their use of the illicit discharge hotline. The phone number for the Illicit Discharge Hotline is posted on the City's website along with contact information for the Stormwater Manager.

The City tracks the system components of the MS4 through a continuously updated GIS system. This system provides information such as pipe size, material, length, and location. It also provides information about outfall locations to the waters of the state. The GIS Technician works with the Maintenance Supervisor and Maintenance Staff to track information about all stormwater maintenance activities that are performed, including screening and cleaning.

Ongoing outreach activities are completed each year to increase awareness about what constitutes an illicit discharge and the actions that can be taken to notify the stormwater utility of suspected illicit discharges. The outreach activities are covered in more detail in the Public Education and Outreach section above. During these outreach activities, the prevention of illicit discharges and the promotion of the illicit discharge hotline is a topic of focus.

Through ongoing stormwater training, City staff has continuing conversations about the IDDE program and uses this time to discuss any changes that may need to be implemented to the program.

When necessary, the Public Works Department relies upon Title 16 of the Richland Municipal Code (RMC) to provide escalating enforcement actions including fines of up to \$100-\$5000/day. Title 16 of the RMC can be found at <http://www.codepublishing.com/WA/Richland/>. A summary of illicit discharge investigations completed during 2019 can be found in Appendix 3.

In 2016, the City created a new stormwater brochure specifically for business outreach. The creation and handout of this brochure completed one of the program goals for 2016. By actively communicating with businesses about the importance of Stormwater in our community, a greater appreciation for water quality is fostered. These brochures will continue to be handed out in 2024.



Program Elements for 2024

In 2024 the existing program for Illicit Discharge Detection and Elimination will continue in accordance with S5. B.3 of the 2019-2024 Permit. Planning and implementation of compliance strategies for the 2019-2024 Permit began when the permit was issued in July 2019, in order to meet all requirements therein.

F. Construction Site Stormwater Runoff Control

Permit Requirements Summary (S5. B.4)

- Implement and enforce a program to reduce pollutants in any stormwater runoff to the MS4 from construction activities that disturb one acre or more, and from construction projects of less than one acre that are part of a larger common plan of development or sale.
- The Permittee shall implement an ongoing process for ensuring proper project review, inspection, and compliance by its own department and agencies. This process should incorporate consideration of potential water quality impacts.
- Implement an ordinance or other regulatory mechanism to require erosion and sediment controls, and other construction-phase stormwater pollution controls at new development and redevelopment projects.
- Implement procedures for site inspection and enforcement of construction stormwater pollution control measures.
- Provide adequate training for all staff involved in permitting, planning, and review.
- Provide information to construction site operators about training available on how to install and effectively maintain effective erosion and sediment controls.

As part of the City's SWMP, an ongoing program is in place to ensure that construction site stormwater runoff is being controlled at both public and privately funded construction projects. The City has adopted regulations, located in the Richland Municipal Code (RMC), which require construction sites to comply with City of Richland Standard Design Guidelines and the Stormwater Management Manual for Eastern Washington. Furthermore, all projects are required to have a Stormwater Pollution Prevention Plan (SWPPP) prepared prior to construction commencing. The portion of the RMC which applies to construction site stormwater runoff is found in Title 16, Chapter 16.06 and is published at this website, <http://www.codepublishing.com/WA/Richland/>.

Privately funded construction projects require a City of Richland issued construction permit. This permit is granted after members of the Public Works department review and approve the construction plans, including the SWPPP. Information for consultants/contractors about construction and post construction stormwater requirements is provided in a handout posted online and available in the Public Works Department.

Program Elements for 2023

In 2024, the existing program for construction site stormwater runoff control will continue in accordance with S5.B.4 of the 2019-2024 Permit. Planning and implementation of compliance strategies for the 2019-2024 Permit began when the new permit was issued in July 2019, in order to meet all requirements therein.

G. Post-Construction Stormwater Management for New Development and Redevelopment

Permit Requirements Summary (S5. B.5)

- Implement an ordinance or other regulatory mechanism that requires post- construction stormwater controls at new development and redevelopment projects.
- Implement procedures for site plan review which incorporate consideration of potential water quality impacts.
- Implement procedures for site inspection and enforcement of post- construction stormwater control measures.
- Provide adequate training for all staff involved in permitting, planning, review, inspection, and enforcement.
- Provide information to design professionals about training available on how to comply with the requirements of Appendix 1 and apply the BMPs described in the Stormwater Management Manual for Eastern Washington
- Keep records of projects, training, and information provided to design professionals.

The City's Municipal Code outlines the regulations for construction and post-construction stormwater management in Chapter 16.06. These regulations give the City the authority to:

- Require construction activities to comply with the City of Richland Design Guidelines and Construction Details and the Stormwater Management Manual for Eastern Washington.
- Require all projects to submit a Stormwater Pollution Prevention Plan.
- Require the property owner to be responsible for continual performance, operation, and maintenance of private stormwater facilities.
- Require an Operations and Maintenance plan for new, permanent stormwater facilities.
- Notifies that all permanent stormwater facilities, BMPs, O&M plans and records shall be subject to inspection by the City.
- Allows the Director, and his designee, the authority to conduct inspections, issues notices of violations, and implement other actions under this title.

City staff continues to review site plans and stormwater pollution prevention plans (SWPPP) for all construction projects. An ongoing inspection program to determine which facilities need to be cleaned and/or repaired will continue. This inspection program will further be reinforced by the IDDE investigations and the post storm spot checks.

In 2017, the City adopted a requirement to retain the 25-year storm event on site. This is more stringent than the 10-year requirement required in the stormwater permit. In 2020, the City adopted a new design requirement of the 3-hour, 50-year storm at sag points, and the 3-hour, 25-year short duration storm for all other locations to adequately size pipes and inlets.

Program Elements for 2023

In 2024, the existing program for Post-Construction Stormwater Management for New Development and Redevelopment will continue in accordance with S5.B.5 of the 2019-2024 Permit. Planning and implementation of compliance strategies for the new 2019-2024 Permit began when the permit was issued in July 2019, in order to meet all requirements therein.

H. Municipal Operations and Maintenance

Permit Requirements Summary (S5. B.6)

- Implement a schedule of municipal Operation and Maintenance activities (an O&M Plan). The O&M Plan was updated August 1, 2017.
- The O&M Plan shall include appropriate pollution prevention and good housekeeping procedures for all of the following types of facilities:
 - Stormwater Collection System
 - Roads, Highways, and Parking
 - Vehicle Fleets
 - Municipal Buildings
 - Parks and Open Space
 - Construction Projects
 - Industrial Activities
 - Material, Equipment, and Maintenance Storage Areas
 - Flood Management Projects
 - Other Facilities Expected to Discharge Contaminated Runoff
- The O&M Plan shall include a schedule of inspections and requirements for record keeping pursuant to S9 Reporting and Recordkeeping.
- Provide training for all employees who have primary construction, operations, or maintenance job functions that are likely to impact stormwater quality.

The City's Operations and Maintenance (O&M) Plan was written in 2016. The implementation of this plan requires the coordination of multiple City departments. This coordination is outlined in the Internal Coordination Procedures document (Appendix 1).

In 2024 the stormwater maintenance crew will continue their screening and cleaning activities to ensure a fully functional MS4 and to meet the O&M Plan requirements.

Training for all staff who have construction, operations, or maintenance job functions will continue in 2024. Qualifying City owned facilities will continue their efforts to update facility specific O&M plans per the 2019-2024 permit.

I. Compliance with Total Maximum Daily Load Requirements

Permit Requirements Summary (S7)

- For applicable TMDLs listed in Appendix 2, affected Permittees shall comply with the specific requirements identified in Appendix 2.

The City does not outfall to any water bodies covered in Appendix 2 of the Permit. No TMDL requirements.

J. Monitoring and Assessment

Permit Requirements Summary (S8)

- All Permittees shall provide, in each annual report, a description of any stormwater monitoring or stormwater-related studies conducted by the Permittee during the reporting period.
- Each city and county shall collaborate with other Permittees to select, propose, develop, and conduct Ecology-approved studies to assess, on a regional or sub- regional basis, effectiveness of permit-required stormwater management program activities and best management practices.

The City of Richland participated with the other Permittees, the Department of Ecology and Evergreen StormH2O, in the Non-Vegetated Filtration Swale Effectiveness Study. During 2022-2023, the City was involved in planning efforts and the execution of the testing phase of the study. This study was considered by the Department of Ecology for a GROSS grant and was chosen as the #1 applicant for funding. The City participated as a member of the Technical Advisory Committee (TAC) and the study was completed in 2023. The results are posted on the City of West Richland's webpage.

During 2023, the City continued to participate in the Drain Rangers Education and Outreach Study, the City of Richland entered into another agreement with Franklin Conservation District and will continue to be involved in the program in 2024.

In 2024, the City of Richland will continue collaboration with other Permittees to complete Effectiveness Study requirements.

K. Reporting and Recordkeeping

Permit Requirements Summary (S9)

- No later than March 31 of each year beginning in 2020, each Permittee shall submit an annual report.
- Each Permittee is required to keep all records related to this permit for at least five years.
- Each Permittee shall make all records related to this permit and the Permittee's SWMP available to the public at reasonable times during business hours.

This SWMP Plan will be submitted along with the annual report questions. The annual report and this Plan will also be posted to the City's website by May 31. The City will continue to keep records to ensure permit compliance.

APPENDIX 1

Stormwater Management Plan Inter- Departmental Coordination Procedures





City of Richland Stormwater Management Plan Inter-Departmental Coordination Procedures

The City of Richland has implemented a Stormwater Management Program (SWMP) to increase awareness of stormwater related issues, protect nearby rivers, and meet the permit requirements of the Eastern Washington Phase II Municipal Stormwater Permit (Permit). This Permit is administered by the Washington State Department of Ecology. In an effort to fully implement the SWMP throughout the City's multiple departments, this internal coordination document has been created to provide structure and definition to the roles that each department will fulfill. This document is intended to satisfy permit requirements as described in Section S5.A.5.b.

Full descriptions of the program components can be found in the SWMP Plan, but a basic outline is as follows:

1. Public Education and Outreach
2. Public Involvement and Participation
3. Illicit Discharge Detection and Elimination
4. Construction Site Stormwater Runoff Control
5. Post-Construction Stormwater Management for New Development and Redevelopment
6. Municipal Operations and Maintenance

Public Education and Outreach

Continually working to educate the general public, including businesses and students, about how the City's municipal separate storm sewer system (MS4) functions is an important component of the SWMP. Creating awareness that anything put into the City's MS4 could ultimately end up in the nearby Columbia and Yakima rivers is a foundational part of this outreach. Outreach activities include annual booths at local events, billing inserts, business outreach, news announcements, and website updates. In order to provide these activities, coordination is needed amongst the following positions.

Public Education and Outreach	
Public Works Department	Assistant City Manager Department
Public Works Director	Assistant City Manager
Stormwater Manager	Communications & Marketing Manager
Public Works Executive Assistant	Environmental Education Coordinator
Civil Engineer I	Communications and Marketing Specialist

Public Involvement and Participation

Providing opportunities for the public to have input on the development of the SWMP is a requirement of the Permit. Each year the City will post a draft version of the SWMP Plan on its website and provide an opportunity for comments electronically. An open house event may also be held during this comment period to allow an opportunity for individuals to ask questions and provide feedback directly to City staff. The procedure for completing this process will require coordination with the Communications and Marketing Manager and the Public Works Executive Assistant to update the website and to inform the public of their opportunity to comment on the program. The Civil Engineer I will collect and analyze the comments and coordinate with the Stormwater Manager and the Public Works Director to determine how best to address the comments.

Public Involvement and Participation	
Public Works Department	Assistant City Manager Department
Public Works Director	Assistant City Manager
Stormwater Manager	Communications & Marketing Manager
Public Works Executive Assistant	Support Specialist
Civil Engineer I	

Illicit Discharge Detection and Elimination

Detecting and eliminating illicit discharges is an important process needed to protect the MS4. The detection of illicit discharges is a shared responsibility of all city staff members who spend time in the field. The general public can also report illicit discharges through the illicit discharge hotline. All suspected illicit discharges reported by City employees and the general public are forwarded to the Public Works department. The investigation and resolution of these suspected illicit discharges is the responsibility of the Public Works department. In cases of continued non-compliance the City Attorney may need to participate when escalated enforcement is needed. The Public Works department is also responsible for ongoing programs to detect and identify illicit discharges, provide training to staff, and track and maintain records, including maps of the MS4.

Construction Site Stormwater Runoff Control

The Permit requires that all permittees “implement and enforce a program to reduce pollutants in any stormwater runoff to the MS4 from construction activities.” This requirement applies to both public and

Private projects. Regulatory authority for this program is found in the City's Municipal Code, Chapter 16.6. This chapter requires that all construction activities, except for small scale maintenance work, comply with the standards found in the City of Richland Standard Design Guidelines and Construction Details and the Stormwater Management Manual for Eastern Washington. Furthermore, all projects are required to submit a Stormwater Pollution Prevention Plan (SWPPP). Before issuing a construction permit, City staff complete a full plan review to ensure that the developer/contractor has a plan in place to meet all stormwater management requirements. After the construction permit has been issued and construction begins, members of City staff provide recurring project inspections. These staff members are Certified Erosion and Sediment Control Lead (CESCL) certified. When staff encounter extreme cases of continued non-compliance, the City Attorney may need to get involved to provide elevated enforcement.

To ensure that City staff are fully prepared for their duties, the City provides ongoing stormwater training to all team members who are, or have the potential to be, involved in construction projects with stormwater runoff. Furthermore, members of City staff who work in plan review and/or complete site inspections maintain their CESCL certification. The Construction Stormwater General Permit requires that site inspections for projects one acre or larger be completed by a staff member who is CESCL certified.

Construction Site Stormwater Runoff Control				
Public Works Department	Energy Services Department	Community and Development Services Dept.	Parks & Public Facilities Dept.	City Attorney Department
Public Works Director	Energy Services Director	Comm. & Dev. Services Director	Parks & Pub. Fac. Director	City Attorney
Stormwater Manager	Electrical Systems Supervisor	Building Inspection Supervisor	Parks & Pub. Facilities Mgr.	Administrative Specialist
WW/SW Maintenance Supervisor	Chief Electrical Engineer	Building Official	Senior Park Planner	
Streets Maint. Supervisor	Electrical Eng. Supervisor	Building Permit Expeditor	Parks & Pub. Fac. Supervisor	
Water Maint. Supervisor	Electrical Engineer II	Building Inspectors		
Civil Engineer I				
Engineering Tech IV				
Engineering Tech III				
Engineering Tech II				

Post-Construction Stormwater Management for New Development and Redevelopment

Post-construction stormwater management is achieved through internal coordination within the Public Works department. Continued inspection of stormwater facilities in the post-construction phase is the responsibility of Public Works staff. The maintenance of publicly owned stormwater facilities is also the responsibility of the Public Works department. However, the maintenance of privately owned stormwater facilities is the responsibility of the land owner per chapter 16.06.050 of the Richland Municipal Code. In the event that the owner of a private facility refuses to address deficiencies, then coordination with the City Attorney may be needed.

Post-Construction SW Management for New/Redevelopment	
Public Works Department	City Attorney Department
Public Works Director	City Attorney
Stormwater Manager	Administrative Specialist
Civil Engineer I	

Municipal Operations and Maintenance

Maintenance operations include ongoing training for City staff, MS4 maintenance, and the implementation of the Operations and Maintenance (O&M) Plan. This plan includes pollution prevention and good housekeeping procedures that must be implemented for:

1. Stormwater collection and conveyance system
2. Roads, highways, and parking lots
3. Vehicle fleets
4. Municipal buildings
5. Parks and open space
6. Construction projects
7. Industrial activities
8. Material storage areas, heavy equipment storage areas and maintenance areas
9. Flood management projects
10. Other facilities that would reasonably be expected to discharge contaminated runoff

Implementation of the O&M plan requires participation by multiple City departments. Provided below is an outline of the departments and managerial positions that need to participate to fully implement the O&M plan.

Municipal Operations and Maintenance				
Public Works Dept.	Energy Services Dept.	Fire and Emergency Services Dept.	Parks & Public Facilities Dept.	Administrative Services
Public Works Director	Energy Services Director	Fire & Emergency Services Director	Parks & Pub. Facilities Director	Administrative Services Director
Trans. & Dev. Manager	Electrical Systems Supervisor	Fire Battalion Chief	Parks & Pub. Facilities Supervisor	Purchasing Manager
WW/SW Manager	Electrical Engineering Supervisor		Parks & Pub. Facilities Mgr.	Equipment Maintenance Supvr.
Capital Improvements Manager				
Water Manager				
WW/SW Maintenance Supervisor				
Streets Supervisor				
Solid Waste Collection Supervisor				
Water Maintenance Supervisor				

Also required is an ongoing maintenance program that focuses on screening and cleaning the MS4. This requires the Maintenance Supervisor to set a schedule for the maintenance team to ensure that the inspection and cleaning requirements of the Permit are met.

Summary

In summary, this document has been created to provide a general outline of the positions and departments that must collaborate in order to fully implement the SWMP. As necessary, other City staff members, not listed in this document, may need to participate to increase the program's effectiveness and implementation.

APPENDIX 2

Utility Billing Stormwater Insert



Additional information regarding the rules and regulations surrounding stormwater pollution can be found at:

City of Richland

www.ci.richland.wa.us/stormwater

Department of Ecology

www.ecy.wa.gov/programs/wq/stormwater/

Environmental Protection Agency

www.epa.gov/npdes/npdes-stormwater-program

If you see someone dumping illegal substances down a City stormwater catch basin, please call the City's Illicit Discharge Hotline at 942-7480.



City of Richland
Wastewater/Stormwater Division
PO Box 190, MS 27
Richland WA 99352



City of Richland
Wastewater/Stormwater Division
PO Box 190, MS 27
Richland WA 99352



Stormwater 5-Minute Survey

Our Commitment To You

The City of Richland is committed to protecting our local rivers, ponds and streams through our stormwater management activities. The citizens of Richland play an important role in protecting the Columbia and Yakima Rivers and Amon Wasteway from the impacts of discharges through the City's stormwater system.

We would appreciate your taking a moment to answer the following questions to help us better understand our stormwater program effectiveness.

Stormwater Survey

Residents of Richland who participate in the survey by completing and returning this postage paid form will be entered in a drawing for one of the following gift cards:

- \$25 to Dutch Bros.
- \$25 to Freddy's
- \$25 to Graze

Survey must be returned by November 15, 2017 in order to be eligible for drawing. Winners will be announced and contacted by November 20, 2017.

To return survey form, fold in thirds with address and pre-paid postage facing out, then tape shut.

Thank you!

1. Which of the following are common pollutants in the drainage off of City streets?

- a) Metals
- b) Asbestos
- c) Fertilizer
- d) Animal waste
- e) Petroleum products
- f) All of the above

2. Where is the stormwater from your neighborhood discharged?

- a) Sewers
- b) Columbia & Yakima Rivers and Amon Wasteway
- c) City parks
- d) Underground vault
- e) Neighborhood pond

3. How is stormwater treated before it reaches the river?

- a) Routed to wastewater plant
- b) Filtered through the ground or not at all
- c) With chlorine
- d) Mobile emergency treatment plants

4. Do you believe stormwater negatively impacts the water quality of our rivers?

- ☐ Yes
- ☐ No

5. What can you do to minimize stormwater pollution at home?

- a) Correctly dispose of household chemicals
- b) Wash vehicles on lawn or at commercial carwashes
- c) Pick up after pets
- d) All of the above

Please include additional comments in the space provided below:

You must include your name, address and phone number to be entered in the drawing for the gift cards.

Name:

Address:

Phone:

Email:

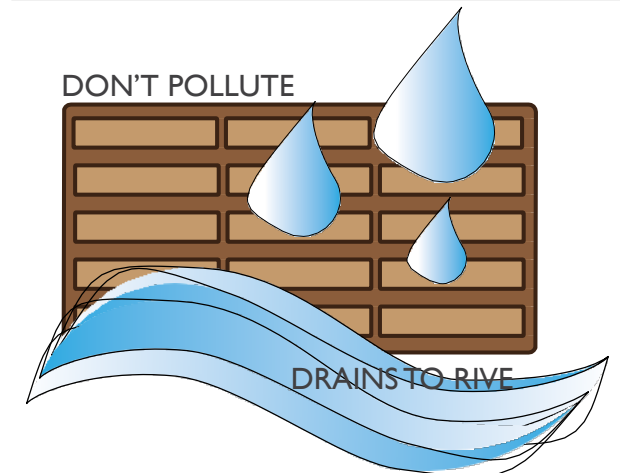

APPENDIX 3

2023 Illicit Discharge Investigations



City of Richland - 2023 IDDE Report

Jurisdiction name and permit number	Date incident discovered	Date beginning response	Date end response	How was the incident discovered or reported to you	Discharge to MS4	Street Address or Intersection	City	Zip	Pollutants Identified	Source or Cause	Correction/elimination methods used
WAR046006	1/30/2023	1/30/2023	1/31/2023	Staff referral, MS4 inspection or screening	No, Cleaned Up	4908 White Dr.	Richland	99352	Sediment/soil	Landscape-related business	Clean-up, Education/technical assistance
WAR046006	1/4/2023	1/4/2023	1/5/2023	Construction inspection	Yes, No Notice Required	Country Club Rd & Bellerive	Richland	99352	Sediment/soil	Construction activity	Clean-up, Education/technical assistance
WAR046006	1/18/2023	1/18/2023	1/19/2023	Construction inspection, MS4 inspection or screening	Yes, No Notice Required	1936 Poplar St	Richland	99352	Sediment/soil	Construction activity	Clean-up, Education/technical assistance
WAR046006	4/4/2023	4/4/2023	4/5/2023	Construction inspection, MS4 inspection or screening	Yes, No Notice Required	2480 Maggio Loop	Richland	99352	Sediment/soil	Landscape-related business, Construction activity	Clean-up, Education/technical assistance
WAR046006	4/15/2023	4/14/2023	4/15/2023	Construction inspection	No, Cleaned Up	2480 Maggio Loop	Richland	99352	Other: Rock Pile in the roadway.	Construction activity	Clean-up, Education/technical assistance
WAR046006	4/14/2023	4/14/2023	4/14/2023	Construction inspection	No, Cleaned Up	1340 Jolianna Dr	Richland	99352	Other: Rock Pile located in the roadway.	Landscape-related business, Construction activity	Clean-up, Education/technical assistance
WAR046006	5/2/2023	5/3/2023	5/3/2023	Construction inspection, MS4 inspection or screening	No, Cleaned Up	1430 Alice	Richland	99352	Sediment/soil	Landscape-related business, Construction activity	Clean-up, Education/technical assistance
WAR046006	5/5/2023	5/5/2023	5/5/2023	Construction inspection, MS4 inspection or screening	No, Cleaned Up	2236 Morency Dr	Richland	99352	Other: Pile of bark in the roadway.	Landscape-related business, Construction activity	Clean-up, Education/technical assistance
WAR046006	5/8/2023	5/9/2023	5/9/2023	Construction inspection, MS4 inspection or screening	No, Cleaned Up	439 Sundance Dr	Richland	99352	Sediment/soil	Landscape-related business, Construction activity	Clean-up, Education/technical assistance
WAR046006	5/9/2023	5/10/2023	5/10/2023	Construction inspection, MS4 inspection or screening	Yes, No Notice Required	2474 Maggio Loop	Richland	99352	Other: Pile of rock in the roadway.	Landscape-related business	Clean-up, Education/technical assistance
WAR046006	5/11/2023	5/12/2023	5/12/2023	Construction inspection, MS4 inspection or screening	No, Cleaned Up	2831 Mackenzie Court	Richland	99352	Other: Pile of rock in roadway.	Landscape-related business	Clean-up, Education/technical assistance
WAR046006	5/12/2023	5/13/2023	5/15/2023	Construction inspection, MS4 inspection or screening	No, Cleaned Up	361 Hanford St	Richland	99352	Other: Pile of rock in roadway.	Landscape-related business	Clean-up, Education/technical assistance
WAR046006	5/11/2023	5/12/2023	5/12/2023	Construction inspection, MS4 inspection or screening	No, Cleaned Up	2121 Hamilton Court	Richland	99352	Sediment/soil, Other: Pile of rock and dirt on sidewalk.	Landscape-related business, Construction activity	Clean-up, Education/technical assistance

City of Richland - 2023 IDDE Report

WAR046006	5/19/2023	5/20/2023	5/20/2023	Construction inspection, MS4 inspection or screening	No, Cleaned Up	1706 Meadow Hills Dr.	Richland	99352	Other: Pile rock in the roadway on Queensgate Dr	Landscape-related business	Clean-up, Education/technical assistance
WAR046006	5/19/2023	5/20/2023	5/20/2023	Construction inspection, MS4 inspection or screening	No, Cleaned Up	1886 Kapalua Ave	Richland	99352	rock on the roadway.	Landscape-related business	Clean-up, Education/technical assistance
WAR046006	5/30/2023	5/31/2023	5/31/2023	Construction inspection, MS4 inspection or screening	Yes, No Notice Required	1401 George Washington Way	Richland	99352	Sewage/sept age/pet waste/human waste	Construction activity	Clean-up, Education/technical assistance
WAR046006	5/30/2023	5/31/2023	5/31/2023	Construction inspection, MS4 inspection or screening	No, Cleaned Up	153 Sherman St	Richland	99352	Other: Pile of rock in the roadway.	Landscape-related business	Clean-up, Education/technical assistance
WAR046006	5/19/2023	5/20/2023	5/20/2023	Construction inspection, MS4 inspection or screening	No, Cleaned Up	534 Lazio Way	Richland	99352	Other: Pile of rock in the roadway.	Landscape-related business	Clean-up, Education/technical assistance
WAR046006	5/30/2023	5/31/2023	5/31/2023	Construction inspection, MS4 inspection or screening	No, Cleaned Up	122 Riverwood Dr	Richland	99352	Other: Pile of rock in roadway.	Landscape-related business	Clean-up, Education/technical assistance
WAR046006	6/2/2023	6/3/2023	6/3/2023	Construction inspection, MS4 inspection or screening	No, Cleaned Up	573 Lazio Way	Richland	99352	Other: Rock pile in the roadway.	Landscape-related business	Clean-up, Education/technical assistance
WAR046006	6/15/2023	6/21/2023	6/16/2023	Construction inspection, MS4 inspection or screening	No, Cleaned Up	1009 Jurupa St	Richland	99352	Other: Pile of rock in roadway.	Landscape-related business	Clean-up, Education/technical assistance
WAR046006	7/5/2023	7/6/2023	7/6/2023	Construction inspection, MS4 inspection or screening	No, Cleaned Up	2223 Harris Rd	Richland	99352	Other: Rock pile in roadway.	Landscape-related business	Clean-up, Education/technical assistance
WAR046006	7/18/2023	7/19/2023	7/19/2023	Construction inspection, MS4 inspection or screening	No, Cleaned Up	312 Saint St	Richland	99352	Sediment/soil	Landscape-related business	Clean-up, Education/technical assistance
WAR046006	7/18/2023	7/19/2023	7/19/2023	Construction inspection, MS4 inspection or screening	No, Cleaned Up	5061 Smitty Road	Richland	99352	Other: Rock and track out in roadway.	Landscape-related business	Clean-up, Education/technical assistance
WAR046006	7/21/2023	7/24/2023	7/24/2023	Construction inspection, MS4 inspection or screening	No, Cleaned Up	1079 Klititat St	Richland	99352	Other: Pile of rock in roadway	Landscape-related business	Clean-up, Education/technical assistance
WAR046006	7/19/2023	7/24/2023	7/24/2023	ERTS referral	Yes, No Notice Required	1329 Lee Blvd	Richland	99352	Soap or cleaning chemicals	Mobile business	Clean-up, Education/technical assistance

City of Richland - 2023 IDDE Report

WAR046006	7/25/2023	7/26/2023	7/26/2023	Staff referral	Yes, No Notice Required	Chinook Dr & Tillamook Dr	Richland	99352	Other: Concrete washout in the catchbasin	Construction activity	Clean-up
WAR046006	7/31/2023	8/1/2023	8/1/2023	Staff referral	No, Cleaned Up	1415 George Washington Way	Richland	99352	Food-related oil/grease	Mobile business	Clean-up, Education/technical assistance
WAR046006	8/16/2023	8/16/2023	8/17/2023	Construction inspection	Yes, No Notice Required	2608 Clark Ridge	Richland	99352	Sediment/soil	Landscape-related business	Clean-up, Education/technical assistance
WAR046006	8/28/2023	9/7/2023	9/11/2023	Pollution hotline (phone, web, app)	Yes, No Notice Required	1536 Rimrock Ave	Richland	99352	Neighbors saw the residence	Other: Residence of 1536 Rimrock Ave	Clean-up, Education/technical assistance
WAR046006	9/7/2023	9/18/2023	9/18/2023	Construction inspection	Yes, No Notice Required	1713 Citrus	Richland	99352	Other: Concrete washout in catchbasin	Construction activity	Clean-up, Education/technical assistance
WAR046006	10/18/2023	10/20/2023	10/19/2023	Staff referral	Yes, No Notice Required	912 Cottonwood Dr	Richland	99352	Other: Dirt and concrete washout was dumped in the storm manhole.	Construction activity	Clean-up, Education/technical assistance
WAR046006	10/31/2023	11/1/2023	11/1/2023	Construction inspection	Yes, No Notice Required	825 Goethals	Richland	99352	Other: Pile of dirt and rock in the roadway.	Construction activity	Clean-up, Education/technical assistance
WAR046006	10/30/2023	11/1/2023	11/1/2023	Direct report to your staff	Yes, No Notice Required	701 Parkway	Richland	99352	Food-related oil/grease	Food-related business	Clean-up, Education/technical assistance
WAR046006	11/3/2023	11/3/2023	11/4/2023	Direct report to your staff	Yes, No Notice Required	1335 Lee Blvd	Richland	99352	Food-related oil/grease	Food-related business	Clean-up, Education/technical assistance
WAR046006	11/8/2023	11/8/2023	11/9/2023	Staff referral	No, Cleaned Up	74 Newcomer	Richland	99352	Other: Rock Pile in the roadway	Landscape-related business	Clean-up, Education/technical assistance
WAR046006	11/29/2023	11/30/2023	11/30/2023	Staff referral	No, Cleaned Up	1196 Brentwood Ave	Richland	99352	Other: Pile of rock in the roadway	Landscape-related business	Clean-up, Education/technical assistance
WAR046006	12/19/2023	12/20/2023	12/20/2023	Staff referral	Yes, No Notice Required	1379 George Washington Way	Richland	99352	Food-related oil/grease	Food-related business	Clean-up, Education/technical assistance

City of Richland - 2023 IDDE Report

WAR046006	12/19/2023	12/21/2023	12/21/2023	Construction inspection	No, Cleaned Up	1639 Livorno Ave	Richland	99352	Other: Two piles of rock in the roadway with mud.	Landscape-related business	Clean-up, Education/technical assistance
WAR046006	12/20/2023	12/21/2023	12/21/2023	Construction inspection, MS4 inspection or screening	No, Cleaned Up	557 Stevens Dr	Richland	99352	Other: mud track out from construction site.	Construction activity	Clean-up, Education/technical assistance, Other: Construction entrance was fixed
WAR046006	2/1/2023	2/1/2023	2/28/2023	Business inspection	Yes, No Notice Required	43 Columbia Pointe Dr	Richland	99352	Food-related oil/grease	Food-related business	Clean-up, Education/technical assistance
WAR046006	2/7/2023	2/8/2023	2/8/2023	Staff referral	Yes, No Notice Required	1606 Salerno Lane	Richland	99352	Sediment/soil	Other: Storm event washed dirt/soil into the roadway.	Clean-up
WAR046006	3/3/2023	3/4/2023	3/4/2023	Construction inspection	No, Cleaned Up	1346 Jolianna Dr	Richland	99352	Other: Rock pile in roadway.	Landscape-related business	Clean-up, Education/technical assistance
WAR046006	4/4/2023	4/5/2023	4/5/2023	Construction inspection	No, Cleaned Up	332 Riverwood St	Richland	99352	Other: Damage to the storm ditch		Other: Contractor reconstructed the drainage ditch.
WAR046006	4/27/2023	5/1/2023	5/1/2023	Staff referral	Yes, No Notice Required	1549 George Washington	Richland	99352	Other: Water leak which was allowing chlorinated water enter the storm system.	Other: Water leak which was allowing chlorinated water enter the storm system.	Other: Fixed the water leak.
WAR046006	5/2/2023	5/3/2023	5/3/2023	Construction inspection	No, Cleaned Up	2363 Harris			Sediment/soil	Landscape-related business	Clean-up, Education/technical assistance
WAR046006	5/2/2023	5/3/2023	5/3/2023	Staff referral	Yes, No Notice Required	1401 George Washington Way	Richland	99352	Sewage/septage/pet waste/human waste	Other accident/spill	Clean-up, Education/technical assistance
WAR046006	5/26/2023	5/27/2023	5/27/2023	Staff referral	Yes, No Notice Required	1401 George Washington Way	Richland	99352	Other: Watermain broke and discharged into the City storm system.	Other accident/spill	Other: Watermain was fixed.

City of Richland - 2023 IDDE Report

WAR046006	6/6/2023	6/13/2023	6/13/2023	Construction inspection	No, Cleaned Up	2149 Davidson	Richland	99352	Other: Pile of concrete and debris in roadway.	Construction activity	Clean-up, Education/technical assistance
WAR046006	7/24/2023	7/25/2023	7/25/2023	Construction inspection	No, Cleaned Up	1238 Meadow Hills Dr.	Richland	99352	Other: Pile of rock in the roadway.	Construction activity	Clean-up, Education/technical assistance
WAR046006	10/13/2023	10/13/2023	10/13/2023	Staff referral	Yes, No Notice Required	2478 Falconcrest Loop	Richland	99352	Other: Draining chlorinated pool water into the City's storm drain.	Mobile business	Education/technical assistance, Other: Stop draining pool water to the catchbasin.
WAR046006	12/15/2023	12/16/2023	12/16/2023	Construction inspection	No, Cleaned Up	426 Riverwood Dr	Richland	99352	Sediment/soil	Construction activity	Clean-up, Education/technical assistance

APPENDIX 4

Port of Benton Interlocal Agreement



INTERLOCAL AGREEMENT

This AGREEMENT, made and entered into this ^{4th} ~~26th~~ day of ^{April} ~~February~~ 2007, between the City of Richland, a Washington Municipal Corporation (hereafter called the "City"), and the Port of Benton, a Washington Municipal Corporation (hereinafter called the "Port"), collectively hereinafter referred to as the "PARTIES".

WHEREAS, the City created a stormwater utility in March 1998 to fund operations, maintenance, capital improvements and administration of its stormwater conveyance and treatment facilities. Operations and maintenance activities include street sweeping, inlet structure and pipeline cleaning, erosion control, etc.; and

WHEREAS, the City established stormwater rates for residential properties in 1998 and commercial properties in 2001; and

WHEREAS, the Port, as owner of commercial properties within the City limits, has been a customer of the City's stormwater utility since 2001; and

WHEREAS, the Port owns and maintains public streets and stormwater conveyance facilities within the City limits; and

WHEREAS, the United States Environmental Protection Agency (EPA) issued Phase II Stormwater regulations under the authority of the Clean Water Act and published in the Federal Register in December 1999; and

WHEREAS, the EPA's regulations name the City of Richland's municipal separate storm sewer system as subject to the Phase II regulations; and

WHEREAS, the Washington State Department of Ecology administers the Phase II regulations in Washington State and has prepared an Eastern Washington Phase II General Stormwater National Pollution Discharge Elimination System (NPDES) Permit that will enforce the Federal Phase II requirements and state water quality regulations on the City's municipal separate storm sewer system; and

WHEREAS, the Washington State Department of Ecology's Phase II NPDES General Permit requires compliance by the Port as a secondary Permittee; and

WHEREAS, the Port desires to contract for stormwater services required to comply with the EPA and Ecology regulations; and

WHEREAS, the City has used funding supplied by its stormwater utility to prepare for compliance with the EPA and Ecology regulations; and

WHEREAS, the City can cost-effectively oversee regulatory compliance for the Port-owned stormwater facilities; and

WHEREAS, RCW 39.34 authorizes interlocal agreements between Washington municipalities

City of Richland - Port of Benton Stormwater Agreement

NOW THEREFORE, in consideration for the mutual covenants, conditions, and terms contained herein, the said PARTIES hereby enter into this agreement as follows:

- 1. The City will provide, under funding from its stormwater utility, street sweeping services on Port-owned public streets to the same standards and frequency as to City-owned public streets. The Port grants the City a right of entry to Port-owned public streets to allow completion of this service.**
- 2. The City will provide, under funding from its stormwater utility, stormwater conveyance system cleaning and maintenance to the same standards and frequency as to City-owned conveyance system facilities. The Port grants the City a right of entry to its stormwater conveyance facilities to allow completion of this service.**
- 3. The City will repair damage to Port-owned streets and stormwater conveyance facilities caused by its implementation of No.'s 1 and 2 above.**
- 4. The Port will provide the City with current data on its leased properties and assist the City in developing billing practices for collecting stormwater utility revenues from Port-owned facilities.**
- 5. The City will correct stormwater utility billings for Port-owned facilities by March 1, 2007 in accordance with parcel data provided by the Port and reviewed by the City.**
- 6. The City will exempt Port-owned public streets and airport facilities utilized primarily by aircraft from the City's stormwater rates.**
- 7. The Port will fund City stormwater activities through payment of the City's stormwater utility rates as adopted by City Council. In establishing stormwater utility rates the City shall treat Port facilities the same as other properties of similar land use within the City. The Port will make payment no later than March 30, 2007 so that all City stormwater utility accounts for Port-owned properties shall be current and without delinquent charges. The City will waive any pending late payment charges on stormwater accounts for Port-owned facilities.**
- 8. Within 180 days of the date of this agreement the Port will provide the City with its most current stormwater facility mapping data for inclusion into the City's stormwater facilities geographical information system (GIS) maps. After the City inputs the Port facilities into its GIS maps the Port will review the maps for accuracy and direct the City to any required corrections.**
- 9. Within 180 days of execution of this agreement the City shall inspect Port-owned stormwater conveyance facilities. The City shall notify the Port of all detected defects. The Port shall be responsible for correction of all identified defects. Once Port repairs are accepted by the City, the City will perform ongoing maintenance and repairs of Port-owned conveyance facilities.**

Since the scope and cost of the defects are unknown at the date of this agreement the City and Port agree that they will evaluate the list of defects after they are identified by the City. The City and Port may elect to negotiate a schedule for completion of repairs or to terminate this agreement if:

- a. The Port determines that the investment required to repair its system defects is too high to justify the benefits provided by the City's stormwater services.**
 - b. The City determines that the cost of ongoing maintenance of Port facilities is too high to justify extending stormwater services to the Port.**
- 10. The Port shall indemnify and hold the City harmless from and against all claims, damages, losses and expenses including attorney fees and court costs, for injury to persons or damage to property which results from or is caused by the negligent or willful act or omission of the Port, its agents or employees.**

City of Richland - Port of Benton Stormwater Agreement

The City shall indemnify and hold the Port, its employees and agents harmless from and against all claims, damages, losses and expenses including attorney fees and court costs, for injury to persons or damage to property which results from or is caused by the negligent or willful act or omission of the City, its subcontractors, agents or employees.

In the event it is determined that the injury to persons or damage to property is caused in part by the negligent act or omission of both the Port and City, then each party shall be liable only to the extent of its percentage of fault. Each party shall contribute to the payment of damages, attorney fees and costs in the same percentage as its percentage of fault in causing the injuries or damages.

- 11. The City will, through funding from its stormwater utility, apply its NPDES Phase II General Stormwater Permit compliance programs to Port-owned stormwater conveyance system facilities. The City agrees to create and administer programs to achieve compliance with Section S6 of the NPDES Phase II permit for Port-owned facilities. The City will prepare program documents and reports as required by the NPDES Phase II permit for Port owned facilities. The Port will cooperate by supplying the City information about its operations and facilities necessary for preparation of compliance documents.**
- 12. The Port will supply the City with all data necessary to achieve compliance with the Washington State Department of Ecology Underground Injection Control Rule for Port-owned stormwater drywells and stormwater injection facilities.**
- 13. The City will include Port-owned stormwater conveyance facilities in any updates to its City-wide Stormwater Management Plan. The City's first Stormwater Management Plan was completed in 2005. There is no scheduled update as of the date of this agreement. The City shall submit any updates to its Stormwater Management Plan for Port review and approval. Port approval of a City Stormwater Management Plan shall not be unreasonably withheld.**
- 14. The City will fund and complete capital improvements to Port-owned stormwater conveyance facilities required by EPA and Ecology regulations or included in a Council adopted Stormwater Management Plan. The City shall submit proposed capital improvements to Port-owned facilities to the Port for review and approval. Port approval of a capital improvement to Port-owned facilities shall not be unreasonably withheld.**
- 15. The Port shall grant the City, without cost to the City, easements and rights-of-way required to implement stormwater construction and maintenance activities.**
- 16. The Port may terminate this agreement by giving the City ninety (90) days written notice of termination. Upon termination, the City shall be relieved of the obligation to provide the services specified in this agreement and the Port shall be responsible for compliance with all stormwater regulations affecting the Port property and facilities.**

This agreement shall not be deemed or construed to be an agreement by the Port as to the validity or enforceability of the Stormwater ordinances adopted by the City or as a waiver of any rights of the Port or its tenants or lessees to contest or challenge the City's Stormwater ordinances.

IN WITNESS WHEREOF, the PARTIES hereto have executed this AGREEMENT as of the day and year above written.

CITY OF RICHLAND

By: 

**John C. Darrington,
City Manager**

PORT OF BENTON

By: 

**Scott D. Keller,
Executive Director**

ATTEST:

Cynthia Johnson, City Clerk

APPROVED AS TO FORM:

Thomas O. Lampson, City Attorney

APPENDIX 5

2023 Annexation Documentation



WHEN RECORDED RETURN TO:

Richland City Clerk's Office
625 Swift Boulevard, MS-07
Richland, WA 99352

ORDINANCE NO. 2023-21

AN ORDINANCE OF THE CITY OF RICHLAND, WASHINGTON, ANNEXING APPROXIMATELY 1,641 ACRES, TO BE KNOWN AS THE NORTHWEST ADVANCED CLEAN ENERGY PARK (FORMERLY THE NORTH HORN RAPIDS INDUSTRIAL PARK), LOCATED WITHIN PORTIONS OF SECTIONS 3, 4, 9, 10, 15 & 16, TOWNSHIP 10 NORTH, RANGE 28 EAST AND PORTIONS OF SECTIONS 33 & 34, TOWNSHIP 11 NORTH, RANGE 28 EAST, W.M., BENTON COUNTY, WASHINGTON, PROVIDING FOR ASSUMPTION OF EXISTING CITY INDEBTEDNESS, AND AMENDING THE OFFICIAL ZONING MAP OF THE CITY OF RICHLAND.

WHEREAS, the City received a notice of intent to annex from the City of Richland's Economic Development Office representing owners of real property described as Assessor's Tax Parcel Nos. 1-1008-100-0001-003, 1-1008-100-0001-004, 1-0308-400-0001-000, 1-3418-300-0001-000, 1-0308-100-0001-000 and 1-3418-300-0002-000, the value of which constituted 100% of the proposed annexation area and so qualified to commence annexation proceedings for annexation into the City of Richland; and

WHEREAS, on September 6, 2022, a meeting was held between the initiating party of this annexation and the Richland City Council, at which time the Council adopted Resolution No. 2022-111, accepting the notice of intention to commence annexation proceedings for the real property legally described in **Exhibit A** attached hereto, subject to simultaneous adoption of the Comprehensive Plan for the proposed annexation area, and the assumption of the appropriate share of all existing City indebtedness; and

WHEREAS, Resolution No. 2022-111 further authorized and directed the Richland Planning Commission to develop and forward a recommendation to the Richland City Council as to the most appropriate zoning designation for the area proposed to be annexed; and

WHEREAS, the Richland Planning Commission held a public hearing on January 25, 2023 to consider an appropriate zoning designation for the proposed annexation area, and recommended adoption of Heavy Manufacturing (M-2) zoning for the property; and

WHEREAS, on February 21, 2023, Richland City Council adopted Resolution No. 2023-24, authorizing the circulation of an annexation petition for annexation of the real property legally described in **Exhibit A** attached hereto; and

WHEREAS, a petition was circulated and signed by the property owners representing 100% of the assessed value of the proposed annexation area, thereby exceeding the state requirement that owners representing at least sixty percent (60%) of the value of the proposed annexation area petition the City for annexation, with such value determined according to the assessed valuation for general taxation; and

WHEREAS, the Richland City Council held a public hearing to consider the annexation on September 5, 2023, which hearing was duly noticed by the City Clerk through publication in a newspaper of general circulation and through the mailing of notice to all property owners within the annexation area, specifying the time and place of the hearing and inviting interested persons to appear and voice approval or disapproval of the annexation; and

WHEREAS, the matter was duly considered by the Richland City Council, and the Council has determined that the annexation would be of general benefit to the residents of the City of Richland.

NOW, THEREFORE, BE IT ORDAINED by the City of Richland as follows:

Section 1. The real property legally described in **Exhibit A** attached hereto is hereby annexed to the City of Richland and is hereby declared to be within the corporate limits of the City of Richland, Benton County, Washington (the “Annexed Area”).

Section 2. The Richland Comprehensive Plan adopted October 3, 2017 by passage of Ordinance No. 45-17, as amended, shall serve as the comprehensive plan for the Annexed Area. All property within the annexation shall be designated as “Industrial” under the land use map that is part of the Richland Comprehensive Plan.

Section 3. It is hereby found, as an exercise of the City’s police power, that the best zoning for the properties included in the Annexed Area shall be Heavy Manufacturing (M-2) as depicted on **Exhibit B**, attached hereto, when consideration is given to the interest of the general public.

Section 4. The property within the Annexed Area shall be assessed and taxed at the same rate and on the same basis as other property within the City, including assessments or taxes in payment for all or of any portion of the outstanding indebtedness of the City, approved by the voters, contracted, or incurred prior to, or existing at the date of annexation.

Section 5. Title 23 of the City of Richland Municipal Code and the Official Zoning Map of the City as adopted by Section 23.08.040 of said title are hereby amended by creating new Sectional Map No. 25 and amending Sectional Map Nos. 1, 3 and 4, all of which are part of a series of maps constituting said Official Zoning Map, as shown on the attached **Exhibit B** bearing the numbers 1, 3, 4 and 25 together with the number and date of passage of this Ordinance, and by this reference made a part of this Ordinance and of the Official Zoning Map of the City.

Section 6. The City Clerk is directed to file a copy of this annexation with the Board of Commissioners of Benton County and the State of Washington in the manner required by law. The City Clerk is also directed to file with the Auditor of Benton County, Washington, a copy of this Ordinance, and shall attach the amended sectional map, as necessary, and an amended Annexation map, all duly certified by the City Clerk as true copies.

Section 7. As authorized and required by RCW 35.13.280, the City shall negotiate a new franchise with the solid waste collection service provider currently serving the Annexed Area on terms that are acceptable to the City and that comply with the City's Solid Waste Management Plan.

Section 8. This Ordinance shall take effect on the day following its publication in the official newspaper of the City of Richland.

PASSED by the City Council of the City of Richland, Washington, at a regular meeting on the 19th day of September, 2023.

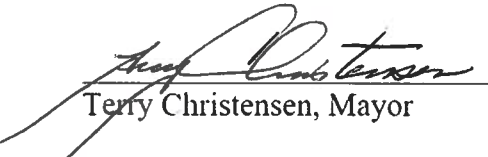
Terry Christensen, Mayor

Attest:

Jennifer Rogers, City Clerk

Approved as to Form:

Heather Kintzley, City Attorney

First Reading: September 5, 2023

Second Reading: September 19, 2023

Date Published: September 24, 2023

EXHIBIT A

Legal Description for Proposed 1,643-Acre Northwest Advanced Clean Energy Park Annexation (Formerly the North Horn Rapids Industrial Park)

The 1,643-Acre Northwest Advanced Clean Energy Park annexation consists of the following:

THOSE PARCELS DEPICTED AS PARCEL A, PARCEL B, PARCEL C, AND PARCEL D ON THAT RECORD OF SURVEY 5069, RECORDED UNDER AUDITOR'S FILE NUMBER 2018-029107 AND FURTHER DESCRIBED AS FOLLOWS:

ENERGY NORTHWEST

Parcels 103081000001000 & 134183000002000

(PARCEL A AS DESCRIBED ON RECORD OF SURVEY 5069)

THAT PORTION OF TRACT 37 OF THE BLM DEPENDENT RESURVEY OF PORTIONS OF TOWNSHIP 10 AND 11 NORTH, RANGE 28 EAST, W.M., BENTON COUNTY, WASHINGTON, ACCORDING TO THE OFFICIAL PLAT THEREOF, APPROVED FEBRUARY 6, 2018, BY THE BLM OFFICE OF CADASTRAL SURVEYS, PORTLAND, OREGON. SAID PORTION OF TRACT 37 BEING MORE PARTICULARLY DESCRIBED AS FOLLOWS:

BEGINNING AT A BLM MONUMENT MARKING ANGLE POINT 19 (AP19) OF TRACT 37 OF SAID SURVEY (SAID POINT ALSO BEING THE NORTHWEST CORNER OF TRACT 38 (AP2) OF SAID SURVEY, SAID POINT BEARS SOUTH 41°32'53"EAST, 2046.25 FEET FROM THE NORTHWEST CORNER OF SECTION 3, OF SAID TOWNSHIP 10 NORTH, RANGE 28 EAST); THENCE NORTH 89°55'49" EAST, 3819.30 FEET ALONG THE NORTH LINE OF SAID TRACT 38 TO A BLM MONUMENT MARKING THE NORTHEAST CORNER OF SAID TRACT 38 (AP1); THENCE NORTH 00°49'09" WEST, 2989.90 FEET ALONG THE EAST LINE OF SAID TRACT 37 TO A BLM WITNESS POINT MONUMENT; THENCE CONTINUING ALONG SAID LINE, NORTH 00°49'19" WEST, 446.90 FEET; THENCE LEAVING SAID EAST LINE, SOUTH 89°55'49" WEST, 3786.13 FEET; THENCE SOUTH 00°15'59" EAST, 3436.53 FEET TO ANGLE POINT 19 (AP19) OF SAID TRACT 37 AND **THE TRUE POINT OF BEGINNING.**

CONTAINING 300.00 ACRES MORE OR LESS.

PORT OF BENTON

Parcels 103084000001000 & 134183000001000

(PARCEL B OF DEED RECORDED UNDER AFN: 2019-018734)

THAT PORTION OF TRACT 37 OF THE BLM DEPENDENT RESURVEY OF PORTIONS OF TOWNSHIP 10 AND 11 NORTH, RANGE 28 EAST, W.M., BENTON COUNTY, WASHINGTON, ACCORDING TO THE OFFICIAL PLAT THEREOF, APPROVED FEBRUARY 6, 2018, BY THE BLM OFFICE OF CADASTRAL SURVEYS, PORTLAND, OREGON. SAID PORTION OF TRACT 37 BEING MORE PARTICULARLY DESCRIBED AS FOLLOWS:

BEGINNING AT A BLM MONUMENT MARKING THE NORTHWEST CORNER OF TRACT 37 (*ANGLE POINT 16*) OF SAID SURVEY; THENCE NORTH 85° 26' 55" EAST, 2675.68 FEET ALONG THE NORTH LINE OF SAID TRACT 37 TO AN ALUMINUM CAP MARKED "BLM WP"; THENCE NORTH 85°27'10" EAST, 2675.63 FEET ALONG SAID NORTH LINE TO THE NORTHEAST CORNER OF SAID TRACT 37 (*ANGLE POINT 17*); THENCE

SOUTH 00°49'19" EAST, 2111.61 FEET ALONG THE EAST LINE OF SAID TRACT 37; THENCE LEAVING SAID LINE, SOUTH 89°55'49" WEST, 3786.13 FEET; THENCE SOUTH 00°15'59" EAST, 3436.53 FEET TO THE NORTHWEST CORNER OF TRACT 38 (*ANGLE POINT 2*) OF SAID SURVEY; (*SAID POINT BEING IDENTICAL WITH ANGLE POINT 19, TRACT 37*) THENCE CONTINUING SOUTH 00°15'59" EAST, 4101.78 FEET ALONG THE WEST LINE OF TRACT 38 TO ANGLE POINT 3 OF SAID TRACT 38; (*SAID POINT BEING IDENTICAL WITH ANGLE POINT 20 OF SAID TRACT 37*); THENCE SOUTH 89°34'39" WEST, 1555.00 FEET TO THE WEST LINE OF SAID TRACT 37; THENCE NORTH 00°21'50" WEST, 377.97 FEET ALONG SAID WEST LINE TO A BLM MONUMENT STAMPED "WP2"; THENCE CONTINUING NORTH 00°21'53" WEST, 3410.37 FEET TO A BLM MONUMENT STAMPED "WP3"; THENCE CONTINUING NORTH 00°21'43" WEST, 3289.12 FEET ALONG THE WEST LINE TO A BLM MONUMENT STAMPED "WP4"; THENCE CONTINUING NORTH 00°21'57" WEST, 2163.99 FEET ALONG SAID WEST LINE TO THE NORTHWEST CORNER OF SAID TRACT 37 AND **THE TRUE POINT OF BEGINNING.**

CONTAINING 503.89 ACRES MORE OR LESS.

PORT OF BENTON

Parcel 110081000001004

(PARCEL C OF DEED RECORDED UNDER AFN: 2019-018734)

THAT PORTION OF TRACT 37 OF THE BLM DEPENDENT RESURVEY OF PORTIONS OF TOWNSHIP 10 AND 11 NORTH, RANGE 28 EAST, W.M., BENTON COUNTY, WASHINGTON, ACCORDING TO THE OFFICIAL PLAT THEREOF, APPROVED FEBRUARY 6, 2018, BY THE BLM OFFICE OF CADASTRAL SURVEYS, PORTLAND, OREGON. SAID PORTION OF TRACT 37 BEING MORE PARTICULARLY DESCRIBED AS FOLLOWS:

COMMENCING AT A BLM MONUMENT MARKING ANGLE POINT 20 (AP20), TRACT 37 OF SAID SURVEY (*SAID POINT BEING IDENTICAL WITH ANGLE POINT 3 (AP3) OF TRACT 38 OF SAID SURVEY, WHICH POINT BEARS SOUTH 00°15'59 " EAST, 4101.78 FEET FROM ANGLE POINT 19 (AP 19) OF SAID TRACT 37*); THENCE SOUTH 45°45'03" EAST, 1801.02 FEET ALONG THE SOUTHWESTERLY LINE OF TRACT 38 OF SAID SURVEY TO THE **TRUE POINT OF BEGINNING**; THENCE CONTINUING SOUTH 45°45'03 " EAST, 575.68 FEET TO A BLM MONUMENT "WP TR38/TR37"; THENCE CONTINUING SOUTH 45°44'49" EAST, 2376.72 FEET ALONG SAID LINE TO ANGLE POINT 21 (AP21) OF SAID TRACT 37 (*SAID POINT BEING IDENTICAL WITH ANGLE POINT 4 OF SAID TRACT 38*); THENCE NORTH 89°58'15" EAST, 420.91 FEET TO ANGLE POINT 22 (AP22) AND THE EAST LINE OF SAID TRACT 37 (*SAID POINT BEING IDENTICAL WITH ANGLE POINT 5 (AP5) OF SAID TRACT 38*); THENCE SOUTH 00°27'34" EAST, 3741.20 FEET ALONG THE EAST LINE OF SAID TRACT 37 TO ANGLE POINT 23 (AP23); THENCE SOUTH 01°16'02" WEST, 409.57 FEET ALONG THE EAST LINE TO THE MOST SOUTHEASTERLY CORNER OF SAID TRACT 37 (*ALSO KNOWN AS ANGLE POINT 1(AP1) OF SAID TRACT 37*); THENCE SOUTH 89°46'43" WEST, 77.68 FEET ALONG THE SOUTH LINE OF SAID TRACT TO A BLM MONUMENT WP TR37 SEC. 15; THENCE SOUTH 89°43'55" WEST, 1812.56 FEET ALONG SAID SOUTH LINE TO ANGLE POINT 2 (AP2) OF SAID TRACT; THENCE LEAVING SAID SOUTH LINE, NORTH 00°00'32" WEST, 1853.05 FEET TO ANGLE POINT 3 (AP3) OF SAID TRACT; THENCE SOUTH 89°59'57" WEST, 566.33 FEET TO THE NORTH-SOUTH CENTERLINE OF SECTION 15 OF SAID TOWNSHIP 10 NORTH, RANGE 28 EAST; THENCE NORTH 01°18'31" WEST, 709.42 FEET TO A BLM MONUMENT MARKING THE NORTH ONE-QUARTER CORNER OF SAID SECTION 15; THENCE CONTINUING NORTH 01°18' 33" WEST, 3657.99 FEET **TO THE TRUE POINT OF BEGINNING.**

CONTAINING 260.11 ACRES MORE OR LESS

CITY OF RICHLAND

Parcel 110081000001003

(PARCEL D OF DEED RECORDED UNDER AFN: 2019-018735)

THAT PORTION OF TRACT 37 OF THE BLM DEPENDENT RESURVEY OF PORTIONS TOWNSHIP 10 AND 11 N, RANGE 28 EAST, W.M., BENTON COUNTY, WASHINGTON, ACCORDING TO THE OFFICIAL PLAT THEREOF, APPROVED FEBRUARY 6, 2018, BY THE BLM OFFICE OF CADASTRAL SURVEYS, PORTLAND, OREGON. SAID PORTION OF TRACT 37 BEING MORE PARTICULARLY DESCRIBED AS FOLLOWS:

BEGINNING AT A BLM MONUMENT MARKING ANGLE POINT 20 (AP20), TRACT 37 OF SAID SURVEY (*SAID POINT BEING IDENTICAL WITH ANGLE POINT 3 (AP3) OF TRACT 38 OF SAID SURVEY, WHICH POINT BEARS SOUTH 00°15'59" EAST, 4101.78 FEET FROM ANGLE POINT 19 (AP19) OF SAID TRACT 37*); THENCE SOUTH 45°45'03" EAST, 1801.02 FEET ALONG THE SOUTHWESTERLY LINE OF TRACT 38 OF SAID SURVEY; THENCE SOUTH 01°18'33" EAST, 3657.99 FEET TO A BLM ALUMINUM MONUMENT MARKING THE SOUTH ONE-QUARTER CORNER OF SECTION 10 OF SAID TOWNSHIP 10 NORTH, RANGE 28 EAST; THENCE CONTINUING SOUTH 01°18'31" EAST, 709.42 FEET TO LINE AP3-AP4 OF TRACT 37 OF SAID SURVEY; THENCE SOUTH 89°59'57" WEST, 1117.97 FEET ALONG SAID LINE TO A BLM MONUMENT MARKING ANGLE POINT 4 (AP4) OF SAID TRACT; THENCE SOUTH 00°00'14" WEST, 1860.73 FEET TO A BLM MONUMENT MARKING ANGLE POINT 5 (AP5) OF SAID TRACT; THENCE SOUTH 89°43'55" WEST, 1604.94 FEET ALONG THE SOUTH LINE OF SAID TRACT TO A BLM MONUMENT MARKING ANGLE POINT (AP6) OF SAID TRACT; THENCE NORTH 00°18'01" EAST, 1436.06 FEET ALONG SAID TRACT TO A BLM MONUMENT MARKING ANGLE POINT 7 (AP7) OF SAID TRACT; THENCE SOUTH 89° 54'27" WEST, 1612.56 FEET TO A BLM MONUMENT MARKING ANGLE POINT 8 (AP8) OF SAID TRACT; THENCE SOUTH 00°12'17" EAST, 1440.92 FEET TO A BLM MONUMENT MARKING ANGLE POINT 9 (AP9) OF SAID TRACT; THENCE SOUTH 89°44'16" WEST, 889.48 FEET TO A BLM MONUMENT MARKING ANGLE POINT 10 (AP10) OF SAID TRACT; THENCE NORTH 01°03'43" WEST, 503.20 FEET TO A BLM MONUMENT MARKING ANGLE POINT 11 (AP11) OF SAID TRACT; THENCE NORTH 89°59'43" WEST, 823.01 FEET TO BLM MONUMENT MARKING ANGLE POINT 12 (AP12) OF SAID TRACT; THENCE NORTH 00°00'36" WEST, 2032.02 FEET TO ANGLE POINT 13 (AP13) OF SAID TRACT; THENCE CONTINUING NORTH 00°00'38" EAST, 446.43 FEET TO ANGLE POINT 14 (AP14) OF SAID TRACT; THENCE SOUTH 88°51'16" EAST, 3129.85 FEET TO ANGLE POINT 15 (AP15) ON THE WEST BOUNDARY OF SAID TRACT (*SAID POINT BEARS NORTH 37°13'18" WEST, 428.71 FEET FROM THE BLM MONUMENT MARKING THE CORNER OF SECTIONS 9-10-15-16 OF SAID TOWNSHIP 10 NORTH, RANGE 28 EAST*); THENCE NORTH 00°21'49" WEST, 2470.20 FEET ALONG SAID WEST BOUNDARY TO A BLM MONUMENT STAMPED "WP1"; THENCE CONTINUING ALONG SAID BOUNDARY, NORTH 00°21'50" WEST, 2102.20 FEET; THENCE LEAVING SAID WEST BOUNDARY, NORTH 89°34'39" EAST, 1555.00 FEET TO ANGLE POINT 20 (AP20) **AND THE TRUE POINT OF BEGINNING.**

CONTAINING 577.25 ACRES MORE OR LESS.

These descriptions include the following Benton County Parcel Identification Numbers:

110081000001003	134183000001000
110081000001004	103081000001000
103084000001000	134183000002000



Exhibit B - Pg. 2 to Ordinance No. 2023-21 Approved 09/19/2023
Annexation of 1,641 Acres and M-2 Zoning

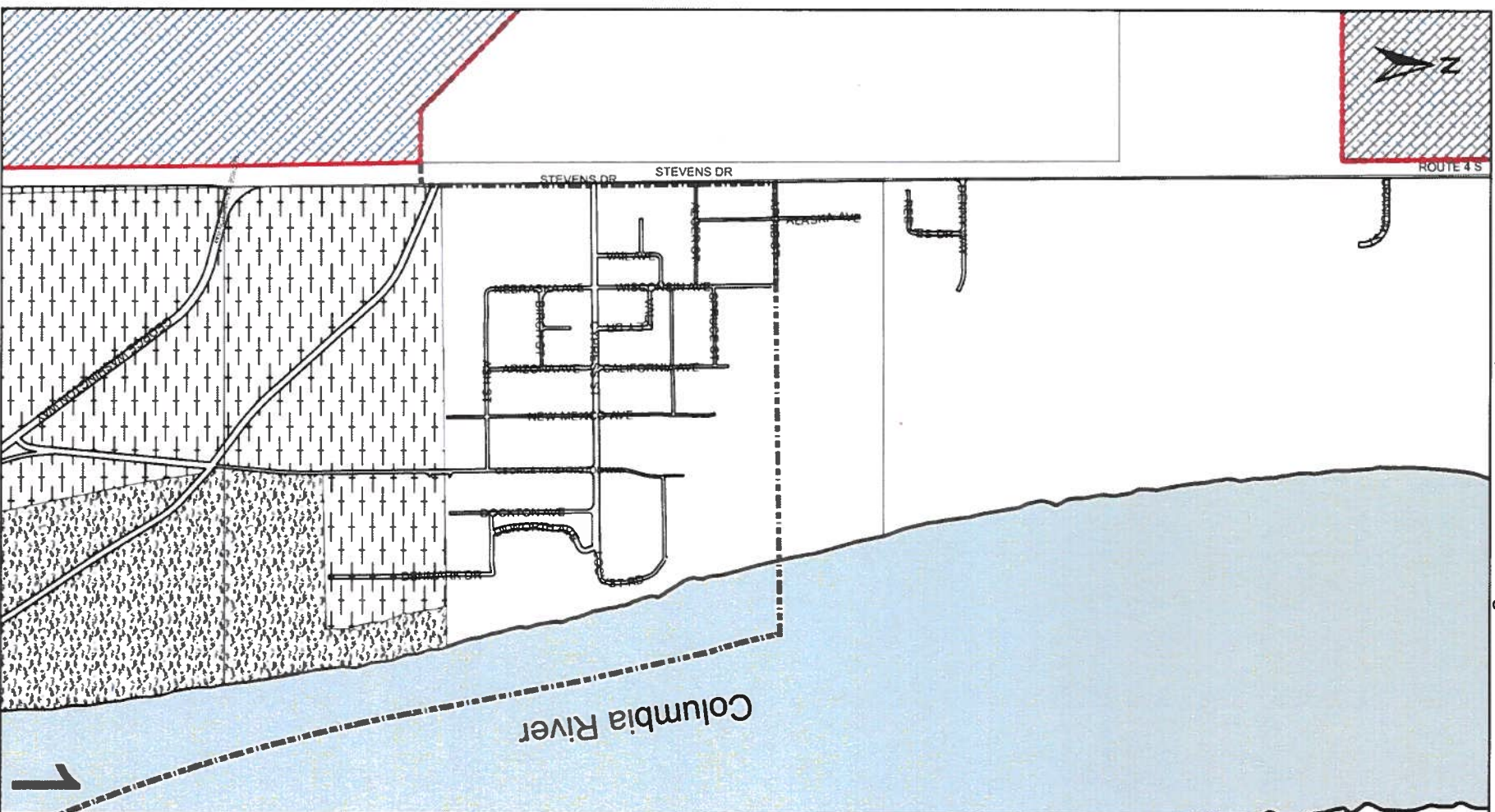

Exhibit B - Pg. 3 to Ordinance No. 2023-21 Approved 09/19/2023
Annexation of 1,641 Acres and M-2 Zoning

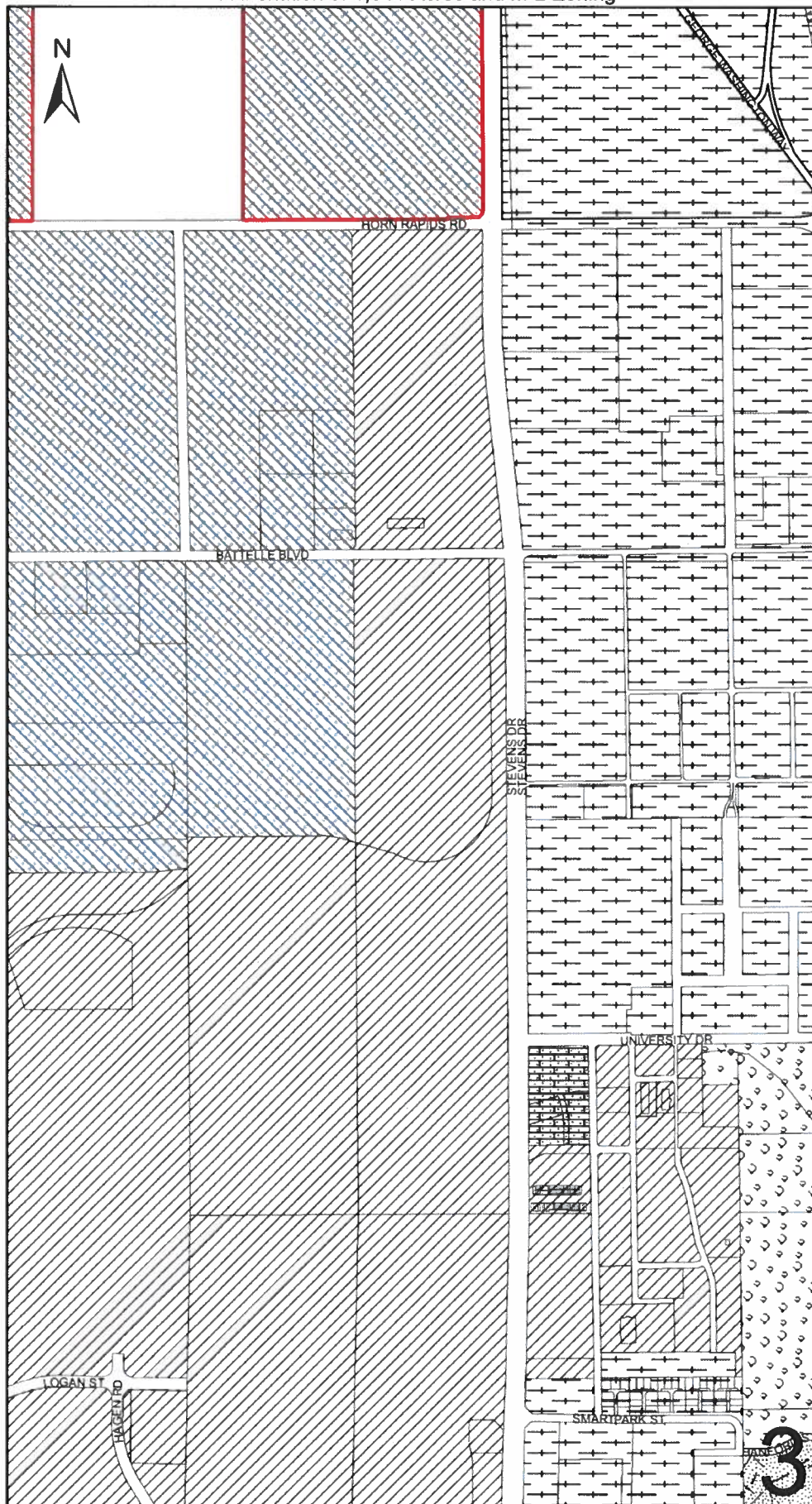
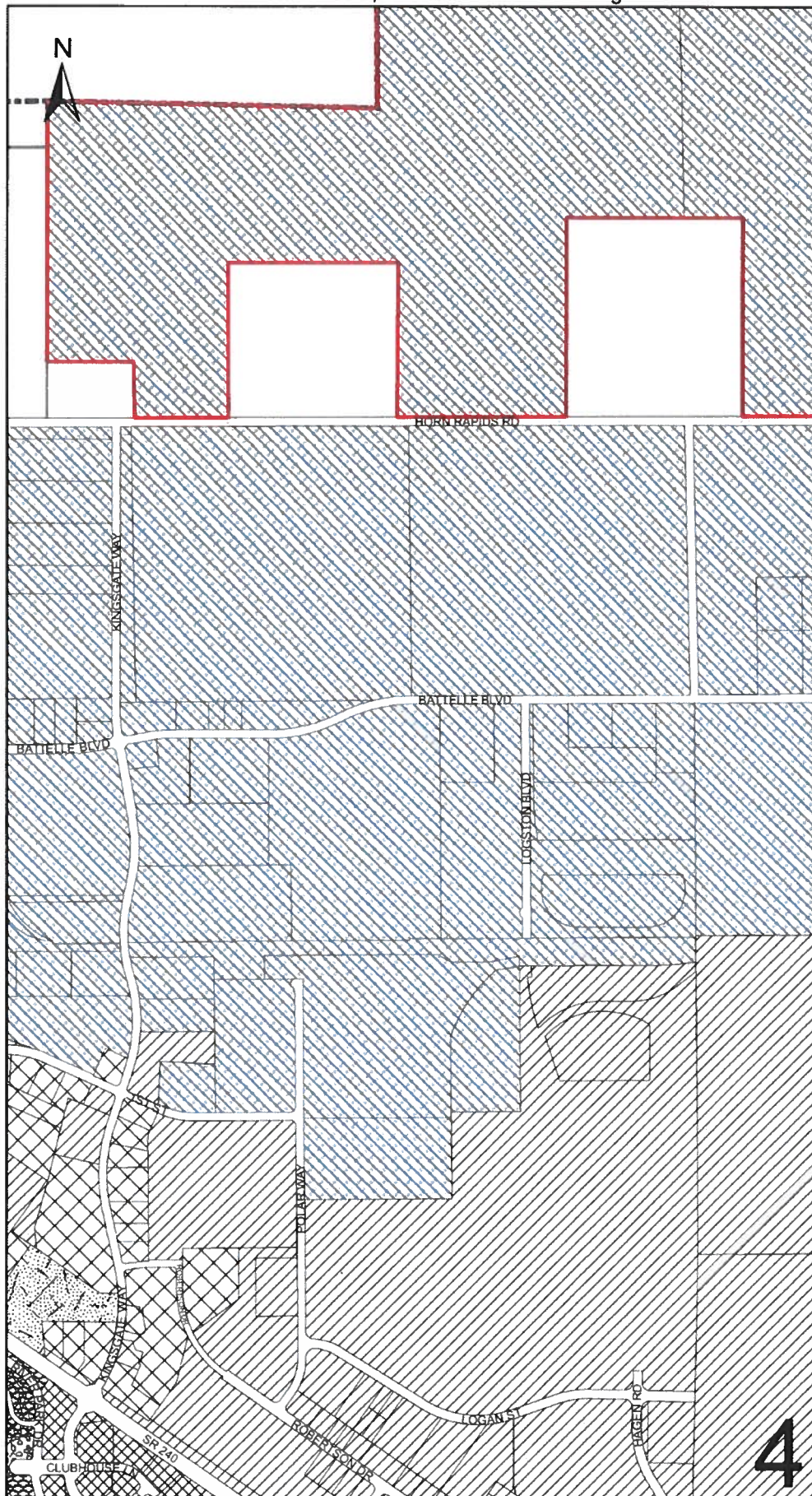

Exhibit B - Pg. 4 to Ordinance No. 2023-21 Approved 09/19/2023
Annexation of 1,641 Acres and M-2 Zoning



WHEN RECORDED RETURN TO:

Richland City Clerk's Office
625 Swift Boulevard, MS-07
Richland, WA 99352

ORDINANCE NO. 2023-32

AN ORDINANCE OF THE CITY OF RICHLAND, WASHINGTON, ANNEXING APPROXIMATELY 1.83 ACRES OF LAND LOCATED AT SHORT PLAT 739, LOT 3, WITHIN PORTIONS OF SECTION 20, TOWNSHIP 9 NORTH, RANGE 28 EAST, W.M., BENTON COUNTY, WASHINGTON, PROVIDING FOR ASSUMPTION OF EXISTING CITY INDEBTEDNESS, AND AMENDING THE OFFICIAL ZONING MAP OF THE CITY OF RICHLAND.

WHEREAS, the City received a notice of intent to annex from Ryan Tucker, owner of real property located at or near 24907 Dallas Road, the value of which constituted 100% of the proposed annexation area and so qualified to commence annexation proceedings for annexation into the City of Richland; and

WHEREAS, on February 21, 2023, a meeting was held between the initiating party of this annexation and the Richland City Council, at which time the Council adopted Resolution No. 2023-26, accepting the notice of intent to commence annexation proceedings for the real property legally described in **Exhibit A** attached hereto, subject to simultaneous adoption of the Comprehensive Plan for the proposed annexation area, and the assumption of the appropriate share of all existing City indebtedness; and

WHEREAS, Resolution No. 2023-26 further authorized and directed the Richland Planning Commission to develop and forward a recommendation to the Richland City Council as to the most appropriate zoning designation for the area proposed to be annexed; and

WHEREAS, the Richland Planning Commission held a public hearing on March 22, 2023 to consider an appropriate zoning designation for the proposed annexation area, and recommended adoption of R-1-10 (single-family residential – 10,000) zoning for the property; and

WHEREAS, on July 6, 2023, Richland City Council adopted Resolution No. 2023-108, authorizing the circulation of an annexation petition for annexation of the real property legally described in **Exhibit A** attached hereto; and

WHEREAS, a petition was circulated and signed by the property owner representing 100% of the assessed value of the proposed annexation area, thereby exceeding the state requirement that owners representing at least sixty percent (60%) of the value of the proposed annexation area petition the City for annexation, with such value determined according to the assessed valuation for general taxation; and

WHEREAS, the Richland City Council held a public hearing to consider the annexation on December 5, 2023, which hearing was duly noticed by the City Clerk through publication in a newspaper of general circulation and through the mailing of notice to all property owners within the annexation area, specifying the time and place of the hearing and inviting interested persons to appear and voice approval or disapproval of the annexation; and

WHEREAS, the matter was duly considered by the Richland City Council, and the Council has determined that the annexation would be of general benefit to the residents of the City of Richland.

NOW, THEREFORE, BE IT ORDAINED by the City of Richland as follows:

Section 1. The real property legally described in **Exhibit A** attached hereto is hereby annexed to the City of Richland and is hereby declared to be within the corporate limits of the City of Richland, Benton County, Washington (the “Annexed Area”).

Section 2. The Richland Comprehensive Plan adopted October 3, 2017 by passage of Ordinance No. 45-17, as amended, shall serve as the comprehensive plan for the Annexed Area. All property within the Annexed Area shall be designated as “Residential” under the land use map that is part of the Richland Comprehensive Plan.

Section 3. It is hereby found, as an exercise of the City's police power, that the best zoning for the properties included in the Annexed Area shall be single-family residential – 10,000 (R-1-10) as depicted on **Exhibit B**, attached hereto, when consideration is given to the interest of the general public.

Section 4. The property within the Annexed Area shall be assessed and taxed at the same rate and on the same basis as other property within the City, including assessments or taxes in payment

for all or of any portion of the outstanding indebtedness of the City, approved by the voters, contracted, or incurred prior to, or existing at the date of annexation.

Section 5. Title 23 of the City of Richland Municipal Code and the Official Zoning Map of the City of Richland, as adopted by Section 23.08.040 of said title, are hereby amended by amending **Sectional Map No. 18**, part of a series of maps constituting said Official Zoning Map, as shown on the attached **Exhibit B** bearing the number 18 together with the number and date of passage of this Ordinance, and by this reference made a part of this Ordinance and of the Official Zoning Map of the City.

Section 6. The City Clerk is directed to file a copy of this annexation with the Board of Commissioners of Benton County and the State of Washington in the manner required by law. The City Clerk is also directed to file with the Auditor of Benton County, Washington, a copy of this Ordinance and shall attach the amended sectional map and an amended Annexation map, duly certified by the City Clerk as a true copy.

Section 7. This Ordinance shall take effect the day following its publication in the official newspaper of the City of Richland.

Section 8. Should any section or provision of this Ordinance be declared by a court of competent jurisdiction to be invalid, that decision shall not affect the validity of the Ordinance as a whole or any part thereof, other than the part so declared to be invalid.

Section 9. The City Clerk and the codifiers of this Ordinance are authorized to make necessary corrections to this Ordinance, including but not limited to the correction of scrivener's errors/clerical errors, section numbering, references, or similar mistakes of form.

PASSED by the City Council of the City of Richland, Washington, at a regular meeting on the 19th day of December, 2023.

Terry Christensen, Mayor

Attest:

Jennifer Rogers, City Clerk

Approved as to Form:

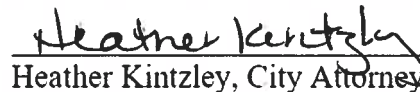
Heather Kintzley, City Attorney

First Reading: December 5, 2023

Second Reading: December 19, 2023

Date Published: December 24, 2023

EXHIBIT A

Legal Description for Short Plat 739, Lot 3 Annexation

The Short Plat 739, Lot 3 annexation consists of the following:

SHORT PLAT NO. 739, LOT 3,

A PORTION OF SECTION 20, TOWNSHIP 9 NORTH, RANGE 28 EAST, W.M., BENTON COUNTY, WASHINGTON.

This description includes the following County Parcel Identification Numbers:

120983010739003

Exhibit B to Ordinance No. 2023-32; Passed 12/19/23
R-1-10 Zoning



APPENDIX 6

2023 Franklin Conservation District Education Report



Franklin Conservation District Education Report
Jr. Drain Rangers, Drain Rangers, and Wheat Week
January – June 2023

Jr. Drain Rangers	# Students	# Teachers	# Lessons
Benton County	1,478	93	78
Kennewick	738	45	37
Canyon View Elementary	60	6	3
Cascade Elementary	96	4	4
Cottonwood Elementary	147	9	8
Hawthorne Elementary	167	10	8
Lincoln Elementary	70	4	4
Ridgeview Elementary	59	5	3
Southgate Elementary	79	4	4
Sunset View Elementary	60	3	3
Richland	448	28	24
Jason Lee Elementary	86	4	4
Jefferson Elementary	74	4	4
Lewis and Clark Elementary	63	3	3
Marcus Whitman	64	8	4
Orchard Elementary	88	5	5
Sacajawea Elementary	73	4	4
West Richland	292	20	17
Desert Sky Elementary	152	10	9
Tapteal Elementary	70	4	4
Wiley Elementary	70	6	4
Franklin County	311	22	15
Pasco	311	22	15
James McGee Elementary	85	10	5
McClintock Elementary	106	7	5
Whittier Elementary	120	5	5
Grand Total	1,789	115	93

Drain Rangers	# Students	# Teachers	# of Lessons
Benton County	285	12	12
Kennewick	113	5	5
Canyon View Elementary	38	2	2
Southgate Elementary	75	3	3
Richland	150	6	6
White Bluffs Elementary	150	6	6
West Richland	22	1	1
Wiley Elementary	22	1	1
Franklin County	153	7	6

Franklin Conservation District Education Report
Jr. Drain Rangers, Drain Rangers, and Wheat Week
January – June 2023

Pasco	153	7	6
Mark Twain Elementary	101	5	4
Ruth Livingston Elementary	52	2	2
Grand Total	438	19	18

Wheat Week	# Students	# Teachers	# Weeks
Kennewick	272	12	4
Amon Creek Elementary	113	5	1
Bethlehem Lutheran School	16	1	1
Cascade Elementary	84	3	1
Ridgeview Elementary	59	3	1
Pasco	323	18	4
Emerson Elementary	53	5	1
Mark Twain Elementary	81	6	1
McGee Elementary	82	3	1
Ruth Livingston Elementary	107	4	1
Richland	103	4	1
White Bluffs Elementary	103	4	1
Grand Total	698	34	9

Teacher Workshops:

February 1 – Drain Rangers – 13 teachers

April 4 – Drain Rangers – 11 teachers

June 20 – Drain Rangers – 6 teachers

Total students taught between January and June 2023 = 2,925

Total teachers taught between January and June 2023 = 198