

FOUNDATION DETAIL

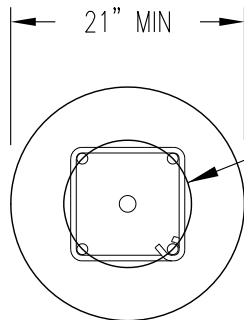

FOUNDATION TOP VIEW

NOTE: CONCRETE STRENGTH = 4000 PSI CONCRETE CLASS 4000P.
 CONCRETE STRENGTH = 2400 PSI PRIOR TO SETTING POLE.

BOLT CIRCLE AS REQUIRED FOR POLE, 10.75" ± 0.25"

SOIL TYPE	CLASS OF MATERIAL (UNIFORM BUILDING CODE)
A	GOOD-COMPACT WELL-GRADED SAND AND GRAVEL. HARD CLAY WELL-GRADED FINE AND COARSE SAND (ALL DRAINED SO WATER WILL NOT STAND)
B	AVERAGE-COMPACT FINE SAND MEDIUM CLAY COMPACT SANDY LOAM LOOSE COARSE SAND AND GRAVEL (ALL DRAINED SO WATER WILL NOT STAND.)
C	POOR-SOFT CLAY CLAY LOAM POORLY COMPACTED SAND CLAYS CONTAINING LARGE AMOUNTS OF SILT (WATER STANDS DURING WET SEASON)

POLE LENGTH (FEET)	MINIMUM FOUNDATION DEPTH IN FEET SEE SOIL TABLE		
	A	B	C
30	5'0"	6'6"	8'0"

NOTE:

- FORMING MATERIALS (SONOTUBE) SHALL BE REMOVED FROM THE TOP OF THE FOUNDATION TO SIX INCHES BELOW FINISHED GRADE.
- SOIL BELOW FOUNDATION TO BE UNDISTURBED.
- SOIL TYPE AS DETERMINED BY THE ENGINEER OR AS SHOWN IN PLANS. 8' MINIMUM FOUNDATION DEPTH SHALL BE USED UNLESS PLANS INDICATE OTHERWISE OR SOIL EVALUATION IS PROVIDED BY THE ENGINEER.



CONCRETE FOUNDATION DETAILS

PUBLIC WORKS ENGINEERING

APPR. BY: PKR

DATE: 11.21

DRAWN BY: LD

DWG: SL3

CAD FILE: 2015_SL3_11_2021